

WHERE BUSINESS MEETS PLEASURE.

When it's time for business, the Inn gets to work. From state-of-the-art electronics infrastructure to comfortably-appointed conference rooms to world-class catering capabilities, we'll help you to maximize every moment. And when business winds down, the pleasure starts—with a roster of world-class activities that put the perfect finishing touch on another successful retreat.



IN THE DETAILS

Imagine a place where simple pleasures become enchanting experiences. Where your every need is attended to with crisp, knowing services. And the meeting you are planning is truly an anticipated event—because of where it is.

LOWER LEVEL

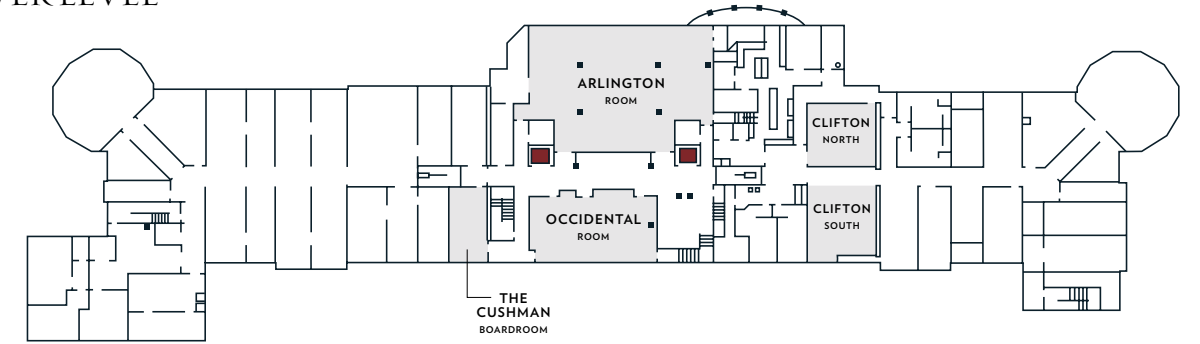

FIRST FLOOR

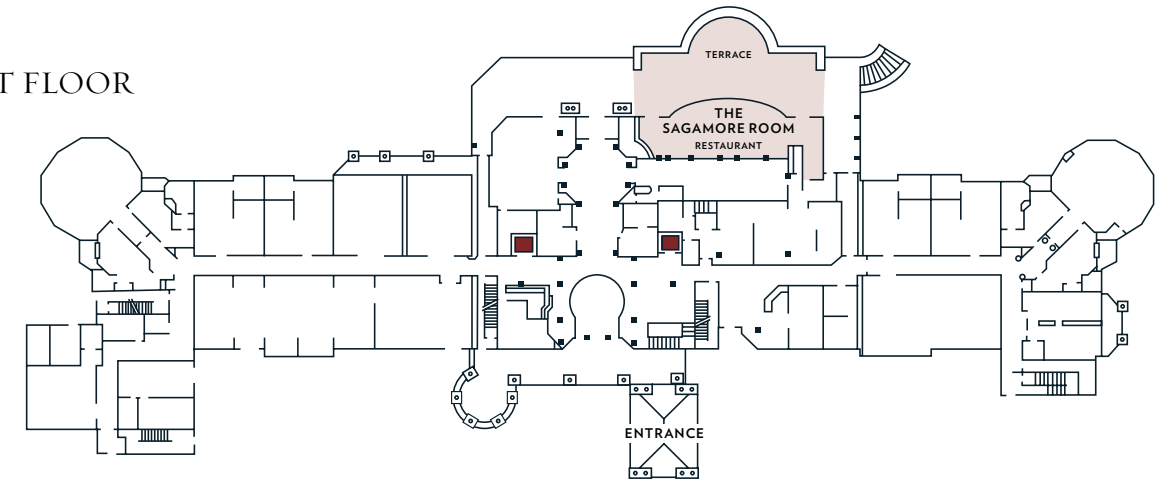

BAY HARBOR GOLF CLUB**

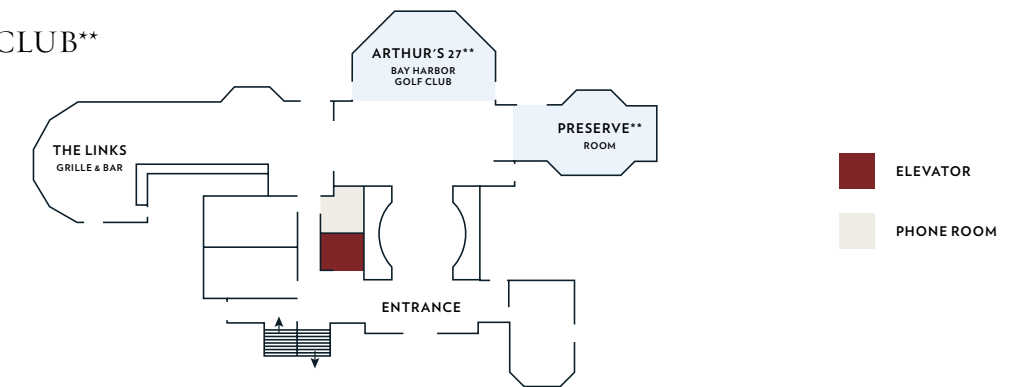

FUNCTION SPACE	DIMENSIONS (width x length)	CEILING HEIGHT	SQUARE FOOTAGE	THEATRE	SCHOOLROOM	CONFERENCE	U-SHAPE	CRESCENT	BANQUET
ARLINGTON	73' x 48'	10'4"	3504'	176	108	40	44	84	180
OCCIDENTAL	50' x 24'	9'6"	1200'	84	40	24	24	42	75
CLIFTON	26' x 58'	8'8"	1508'	150	64	48	39	56	90
CLIFTON NORTH	26' x 23'	8'8"	598'	60	24	16	20	21	30
CLIFTON SOUTH	26' x 35'	8'8"	910'	96	40	24	32	42	45
CUSHMAN BOARDROOM	15' x 26'	9'6"	390'	•	•	12	•	•	•
THE SAGAMORE ROOM	69' x 47'	9'4"	3315'	•	•	•	•	•	150
BAY HARBOR GOLF CLUB**	•	•	•	•	•	•	•	•	120
ARTHUR'S 27**	30' x 35'	•	•	•	•	•	•	•	90
PRESERVE**	17' x 33'	•	•	•	•	•	•	•	30

**BAY HARBOR GOLF CLUB IS LOCATED THREE MILES FROM THE RESORT. SEASONAL AVAILABILITY.

SHOULD YOUR EVENT REQUIRE A HOSPITALITY SUITE, PLEASE INQUIRE ABOUT OUR PENTHOUSE.